

2-4-2 UNIVERSAL 90°  
(PLAN/SIDE)

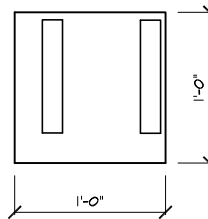

2-4-2 (SHORTIE 90°)

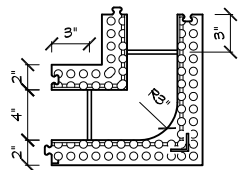
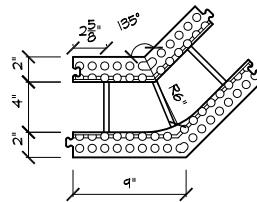

2-4-2 (SHORTIE 45°)



Since 1967

Insulated Concrete Forms

Greenblock Worldwide Corporation  
759 S. Federal Highway, Suite 213  
Stuart, Florida 34994  
Phone: 772-223-8045  
Fax: 772-334-5554  
Toll Free: 1-800-216-1820

www.Greenblock.com

2-4-2 BLOCK

REVISED DATE:

DRAWN BY:

AEG CONSULTANTS, INC. (JML)

DATE:

JAN. 28, 2009

SCALE:

3/4" = 1'-0"

DETAIL NUMBER:

GB-54

DISCLAIMER NOTICE: SPECIFIC INFORMATION FOR COMPLIANCE WITH LOCAL CODES, CONSTRUCTION PRACTICES AND REQUIREMENTS IS RESPONSIBILITY OF THE DESIGNER REGARDLESS OF DETAILS SHOWN IN DRAWING. GREENBLOCK WORLDWIDE CORPORATION RESERVES THE RIGHT TO CHANGE THE INFORMATION SHOWN WITHOUT NOTICE.