

FACE SCREW

DETAIL ABOVE IS A GENERAL DRAWING ONLY. FOLLOW MANUFACTURER'S INSTALLATION INSTRUCTIONS

TABLE 82A – FACE SCREW ATTACHMENT SPACING (in.)

PLANK WIDTH	110 MPH, EXP. CAT C		150 MPH, EXP. CAT C	
	VERT.	HORIZ.	VERT.	HORIZ.
4.00"	4	12	4	12
6.00"	6	12	6	12
6.25"	6.25	12	6.25	12
7.50"	7.5	12	7.5	6
8.00"	8	12	8	6
8.25"	8.25	12	8.25	6
9.50"	9.5	12	9.5	6
12.00"	12	12	12	6

NOTES:

- REFERENCES: ICC LEGACY REPORT NER-405, DATED 4/1/2004
INTERTEK REPORT #3175443MID-001, DATED 4/29/2009
INTERTEK REPORT #3154892MID-003, DATED 7/29/2008
- #8 SCREWS TO BE SELF-DRILLING, CORROSION RESISTANT, RIBBED AND BUGLE HEAD.

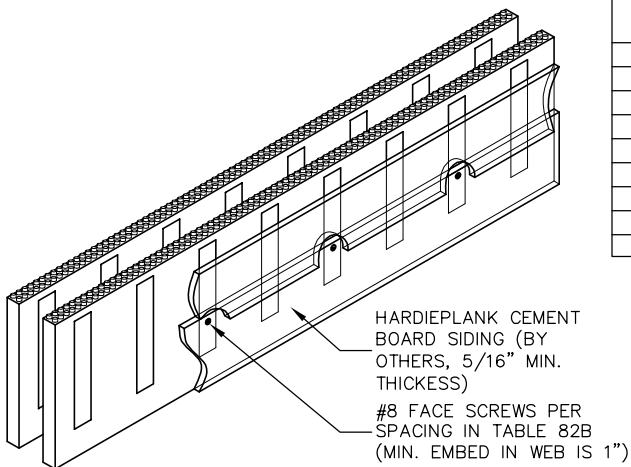

BLIND SCREW

DETAIL ABOVE IS A GENERAL DRAWING ONLY. FOLLOW MANUFACTURER'S INSTALLATION INSTRUCTIONS

TABLE 82B – BLIND SCREW ATTACHMENT SPACING (in.)

PLANK WIDTH	110 MPH, EXP. CAT C		150 MPH, EXP. CAT C	
	VERT.	HORIZ.	VERT.	HORIZ.
4.00"	4	6	*	*
6.00"	6	6	*	*
6.25"	6.25	6	*	*
7.50"	*	*	*	*
8.00"	*	*	*	*
8.25"	*	*	*	*
9.50"	*	*	*	*
12.00"	*	*	*	*

* BLIND SCREW ATTACHMENT NOT RECOMMENDED



Greenblock Worldwide Corporation
759 S. Federal Highway, Suite 213
Stuart, Florida 34994
Phone: 772-223-8045
Fax: 772-334-5554
Toll Free: 1-800-216-1820
www.Greenblock.com

HARDIEPLANK SIDING ATTACHMENT

REVISED DATE:	DRAWN BY: CAI
DATE: OCT 20, 2010	SCALE: 3/4" = 1'-0"
DETAIL NUMBER	GB-82

DISCLAIMER NOTICE: SPECIFIC INFORMATION FOR COMPLIANCE WITH LOCAL CODES, CONSTRUCTION PRACTICES AND REQUIREMENTS IS THE RESPONSIBILITY OF THE DESIGNER REGARDLESS OF DETAILS SHOWN IN DRAWING. GREENBLOCK WORLDWIDE CORPORATION RESERVES THE RIGHT TO CHANGE THE INFORMATION SHOWN WITHOUT NOTICE.